

NOTE:  
 1.MATERIAL SPECIFICATION:  
 1.HOUSING:HIGH TEMPERATURE RESISTANT PLASTIC,UL94 V-0.  
 2.CONTACTS: COPPER ALLOY(C1814)  
 3.MID PLATE: STAINLESS STEEL(SUS301)  
 4.FRONT SHELL: STAINLESS STEEL(SUS304)  
 2.PLATING SPECIFICATION:  
 2-1.TERMINAL:  
 Ni 50u" MIN. UNDER PLATED OVER ALL.  
 Au PLATED ON THE FUNCTIONAL AREA OF CONTACT.  
 (GOLD PLATING THICKNESS FOLLOW THE P/N)  
 PLATING SPECIFICATIONS OF THE SOLDER AREA FOLLOW THE P/N  
 2-2.FRONT SHELL:  
 PLATING SPECIFICATIONS FOLLOW THE P/N  
 2-3.MID PLATE&:  
 CLEAR ONLY  
 3.MECHANICAL PERFORMANCE,  
 3-1.INSERTION FORCE: 0.5~2.0kgf.  
 3-2.REMOVAL FORCE: 0.8kgf~2.0kgf.  
 3-3.DURABILITY: 10000 CYCLES.  
 4.ELECTRICAL PERFORMANCE,  
 4-1. CURRENT RATING:5.0A  
 VOLTAGE RATING:5.0V  
 4-2. LLCR: VBUS & GND PINS AND OTHER PINS: 40mΩ/PIN MAX.  
 SHIELD: 50mΩ/MAX.  
 LLCR MAX. CHANGE OF ALL PINS: 10mΩ.  
 4-3.INSULATION RESISTANCE: 100MΩ MIN  
 4-4.DIELECTRIC WITHSTAND VOLTAGE,AC 100V FOR 1 MINUTE.  
 5. ENVIRONMENTAL PERFORMANCE:  
 OPERATING TEMPERATURE: -25°C~+85°C.  
 6.IR REFLOW:  
 THE PEAK TEMPERATURE ON THE BOARD SHALL  
 BE MAINTAINED FOR 10 SECONDS AT 260°C.

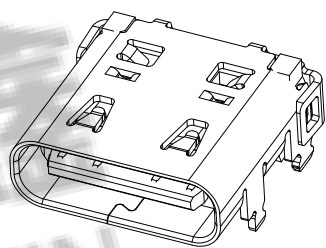

料号编码:

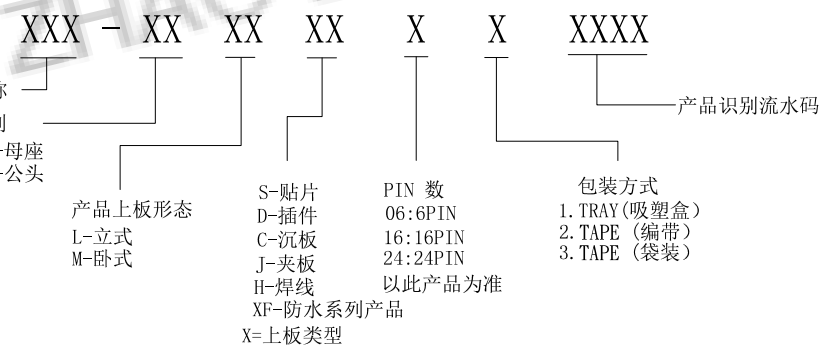

**ZDX** 深圳市兆达鑫科技有限公司  
 Shenzhen zhaodaxin Technology Co., Ltd

|                                             |             |                               |             |               |
|---------------------------------------------|-------------|-------------------------------|-------------|---------------|
| TITLE:TYPE-C/F 16PIN端子双排插<br>L=8.97MM 外壳带弹片 |             | PART NO.:ZDX-CFMD162SH01      |             |               |
| 工程图                                         |             | TEL:0755-29888153             |             |               |
| THIRD ANGLE PROJECTION                      |             | WEB: http://www.szzdjmkj.com/ |             |               |
|                                             | UNIT:<br>mm | SCALE:<br>1:1                 | SIZE:<br>A4 | SHEET:<br>1/3 |

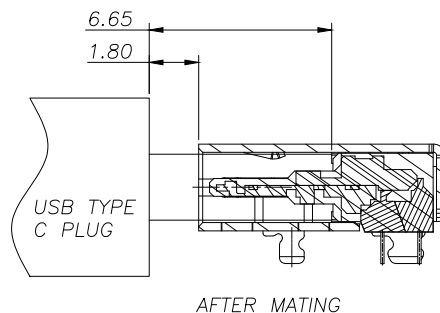

AFTER MATING

USB TYPE-C PIN ASSIGNMENTS

| PIN NUMBER | SIGNAL NAME | PIN NUMBER | SIGNAL NAME |
|------------|-------------|------------|-------------|
| A1         | GND         | B12        | GND         |
| A4         | Vbus        | B9         | VBUS        |
| A5         | CC1         | B8         | SBU2        |
| A6         | Dp1         | B7         | Dn2         |
| A7         | Dn1         | B6         | Dp2         |
| A8         | SBU1        | B5         | CC2         |
| A9         | Vbus        | B4         | VBUS        |
| A12        | GND         | B1         | GND         |

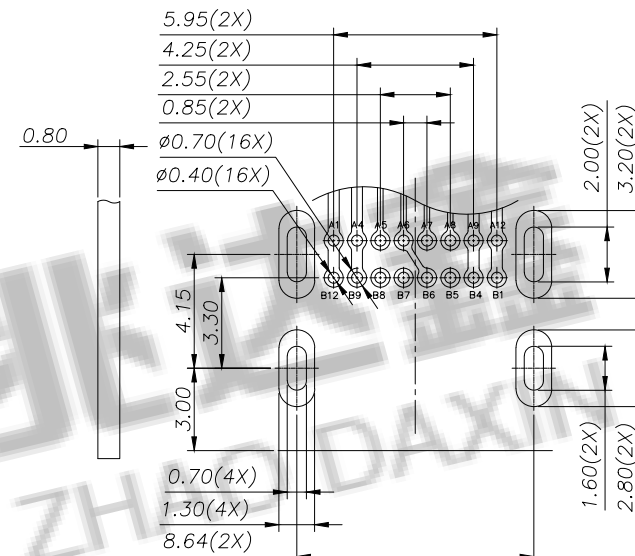

RECOMMENDED PCB LAYOUT(TOP VIEW)

DEFAULT TOLERANCE:±0.05

**ZDX** 深圳市兆达鑫科技有限公司  
Shenzhen zhaodaxin Technology Co., Ltd

TITLE: TYPE-C/F 16PIN端子双排插  
L=8.97MM 外壳带弹片

PART NO.: ZDX-CFMD162SH01

TEL: 0755-29888153

工程图

WEB: <http://www.szzdjmkj.com/>

THIRD ANGLE PROJECTION

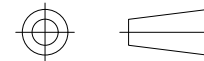

UNIT:

mm

SCALE:

1:1

SIZE:

A4

SHEET:

2/3

RoHS Compliant

Halogen Free

customer drawing

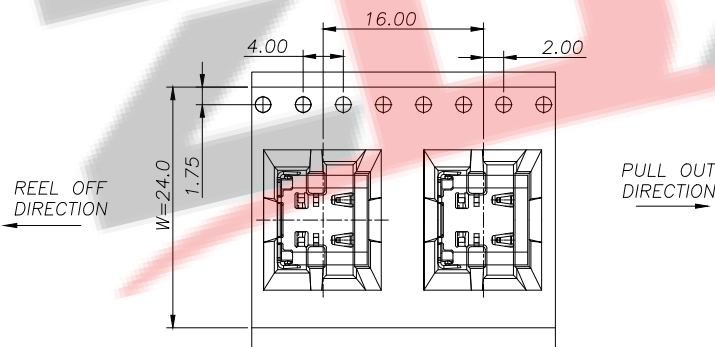
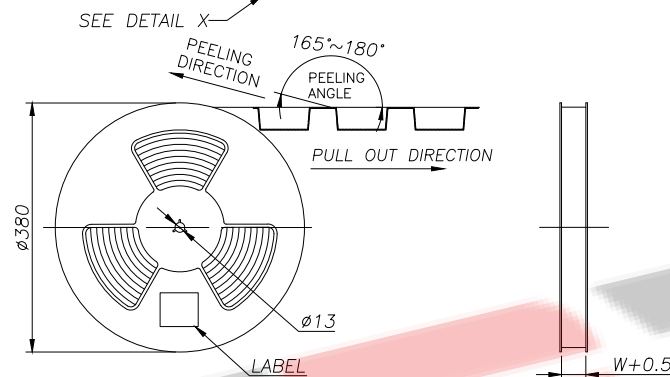
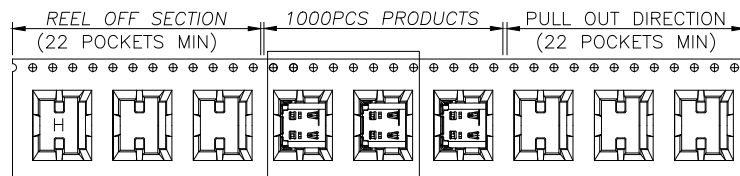

DETAIL X  
SCALE 2:1

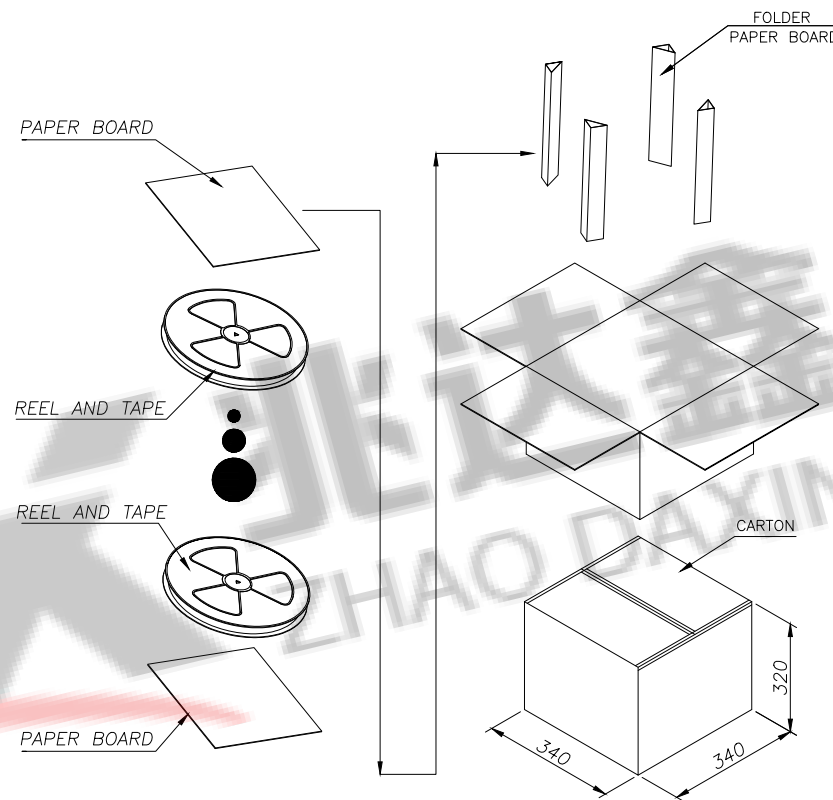

|                 |           |        |
|-----------------|-----------|--------|
|                 | REEL/TRAY | CARTON |
| CONNECTOR (PCS) | 1000      | 10000  |

**ZDX** 深圳市兆达鑫科技有限公司  
Shenzhen zhaodaxin Technology Co., Ltd

TITLE: TYPE-C/F 16PIN端子双排插  
L=8.97MM 外壳带弹片

PART NO.: ZDX-CFMD162SH01

TEL: 0755-29888153

工程图

WEB: <http://www.szzdjmj.com/>

THIRD ANGLE PROJECTION

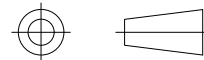

UNIT:

mm

SCALE:

1:1

SIZE:

A4

SHEET:

3/3